

PRODUCT BENEFITS

- + FLAT: Flat for easy handling and bench work
- + Round for up to 1008 fibers
- + SIMPLE: Cable input/output ports accommodate a wide range of diameters for ease of use
- + RUGGED: IP68 watertight seal, UV-resistant material
- + INTUITIVE: Choose from different cassettes for easy splice identification
- + INNOVATIVE: Integrate RFID tags for easy box identification

PRÉSENTATION

Omelcom AMPHIBOX boxes are used for FTTx deployment in underground or pole-mounted applications.

The flat form factor makes it easy to lay the box down horizontally for splicing. It also makes wall-mounted and in-cabined installation easier.

The round box makes it possible to splice up to 1008 fibers inside one compact box on two side rack.

The box's multi-cable seals are compatible with a wide range of diameters and are easy to install. For instance, just three different AMPHIBOX models cover the diameter range from 6 OF to 288 OF cables.

Omelcom AMPHIBOX boxes are also equipped with cassettes so that you can adapt the content of each box and expand later.



Our optional RFID system is a great way to trace and protect your assets.



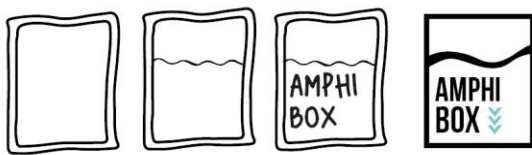

AERIAL AND UNDERGROUND CONNECTION

144 & 288 & 1008 OF BOXES

BOX SELECTION



BASE

SIZE M

SIZE L

VOLUME = 6,9 L

VOLUME = 8,5 L

Dimensions : 150x240x320 mm

Dimensions : 150x240x390 mm

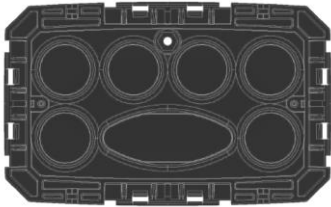

1 oval port 32x80 mm
6 round ports \varnothing 32 mm

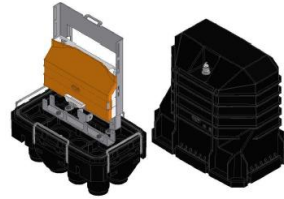

AMPHIBOX FLAT M

Max. tray blocks : 2
Splice capacity : 144

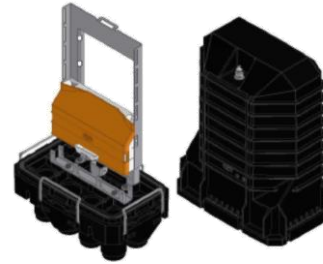

AMPHIBOX FLAT L

Max. tray blocks : 4
Splice capacity : 288

BASE

SIZE XXL

VOLUME =

Dimensions : \varnothing 320x566 mm

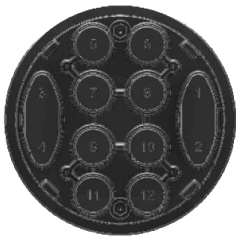

2 oval ports 32x80 mm
8 round ports \varnothing 32 mm



AMPHIBOX XXL

Max. tray blocks : 84
Splice capacity: 1008

MOUNTS

MOUNTING KIT

USE

AMPHIBOX-FIX



Kit for mounting in cable manholes or on poles for UBOX Flat

AMPHIBOX-ROUND-FIX



Kit for mounting in cable manholes for UBOX Round



Dans le soucis de mieux servir ses clients et d'améliorer les performances de ses produits, OMELCOM se réserve la possibilité de modifier les présentes caractéristiques sans notification préalable

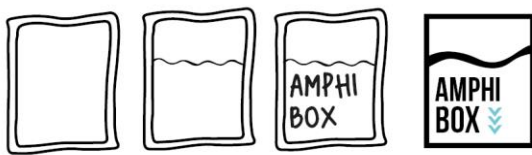

PORTS

TYPE OF MECHANICAL PORTS	i/O NUMBER	COMPATIBLE DIAMETERS
AMPHIBOX-POM-2X16mm	2	5 mm ≤ \varnothing ≤ 16,5 mm
AMPHIBOX-POM-2X20mm	2	7 mm ≤ \varnothing ≤ 20,5 mm
AMPHIBOX-POM-4X10mm	4	5 mm ≤ \varnothing ≤ 10 mm
AMPHIBOX-PRM-1X20mm	1	15 mm ≤ \varnothing ≤ 20,5 mm
AMPHIBOX-PRM-1X16mm	1	10 mm ≤ \varnothing ≤ 16,5 mm
AMPHIBOX-PRM-4X8mm	4	5 mm ≤ \varnothing ≤ 8,5 mm
AMPHIBOX-PRM-8X7mm	8	3 mm ≤ \varnothing ≤ 7,3 mm
AMPHIBOX-PRM-2X12mm	2	8 mm ≤ \varnothing ≤ 12,5 mm
AMPHIBOX-PRM-4X10mm	4	6 mm ≤ \varnothing ≤ 10,5 mm
AMPHIBOX-PRM-12X4mm	12	0 mm ≤ \varnothing ≤ 4,5 mm

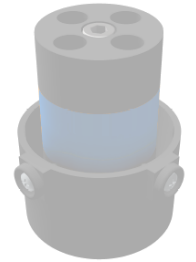
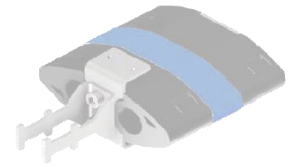

TYPE OF THERMO PORTS	i/O NUMBER	COMPATIBLE DIAMETERS
AMPHIBOX-POT-2X27mm	2	10 mm ≤ \varnothing ≤ 27 mm
AMPHIBOX-PRT-1X30mm	1	10 mm ≤ \varnothing ≤ 30 mm



TRAYS

TYPE OF TRAY	CAPACITY	COMPATIBILITY
AMPHIBOX-BK7-6-12S	Number of trays per block : 6 Number of smoooves par tray (ø2,5x45 mm) : 12	Fibre G652 et G657
AMPHIBOX-BK7-6-2x6S	Number of trays per block : 6 Number of smoooves par tray (ø2,5x45 mm) : 12 (6 on each side)	Fibre G652 et G657
UBOX-BK7-3-2PLC	Number of trays per block : 3 Number of μ -smoooves par tray (ø1,4x40 mm) : 32 Number of PLC splitter (4x7x50 mm) : 2	Fibre G652 et G657

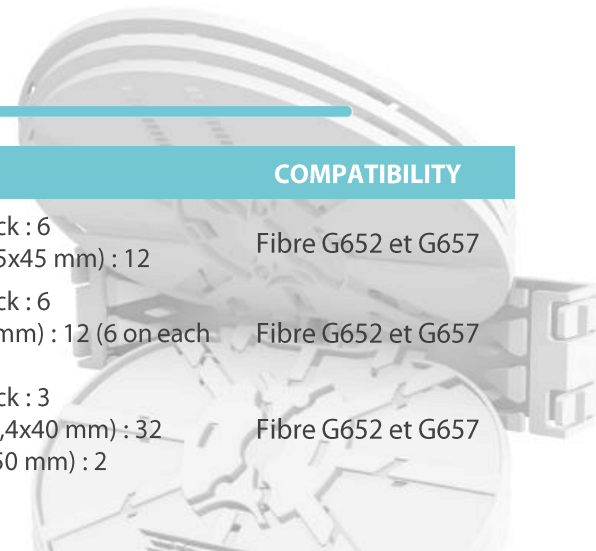

Dans le soucis de mieux servir ses clients et d'améliorer les performances de ses produits, OMELCOM se réserve la possibilité de modifier les présentes caractéristiques sans notification préalable

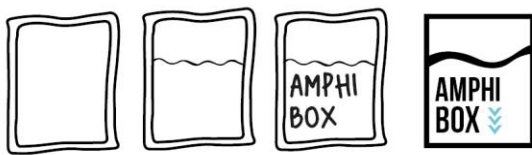

AERIAL AND UNDERGROUND CONNECTION

144 & 288 & 1008 OF BOXES

PART NUMBER

	FAMILY	P/N	DESCRIPTION	
BOX	AMPHIBOX FLAT M	CO450	IP68 SPLICE BOX 144OF	
	AMPHIBOX FLAT L	CO460	IP68 SPLICE BOX 288OF	
	AMPHIBOX ROUND XXL	CO480	IP68 SPLICE BOX 1008OF	
INPUT/OUTPUT PORTS	AMPHIBOX-POM-2X16mm	CO500	OVAL MECHANICAL PORT 2X16 mm	
	AMPHIBOX-POM-2X20mm	CO501	OVAL MECHANICAL PORT 2X20 mm	
	AMPHIBOX-POM-4X10mm	CO502	OVAL MECHANICAL PORT 4X10 mm	
	AMPHIBOX-PRM-1X20mm	CO503	ROUND MECHANICAL PORT 1X20 mm	
	AMPHIBOX-PRM-1X16mm	CO504	ROUND MECHANICAL PORT 1X16 mm	
	AMPHIBOX-PRM-4X8mm	CO505	ROUND MECHANICAL PORT 4X8 mm	
	AMPHIBOX-PRM-8X7mm	CO506	ROUND MECHANICAL PORT 8X7 mm	
	AMPHIBOX-PRM-2X12mm	CO507	ROUND MECHANICAL PORT 2X12 mm	
	AMPHIBOX-PRM-4X10mm	CO508	ROUND MECHANICAL PORT 4X10 mm	
	AMPHIBOX-PRM-12X4mm	CO509	ROUND MECHANICAL PORT 12X4 mm	
	AMPHIBOX-POT-2X27mm	CO518	ROUND MECHANICAL PORT 2X27 mm	
	AMPHIBOX-PRT-1X30mm	CO519	ROUND MECHANICAL PORT 1X30 mm	
	TRAYS	AMPHIBOX-BK7-6-12S	CO520	BLOCK 6 TRAYS 12 OF G652D
		AMPHIBOX-BK7-6-2x6S	CO521	BLOCK 6 TRAYS BIFACE 12OF G652D
AMPHIBOX-BK7-3-2PLC		CO522	BLOCK 3 TRAYS 2 SPLITTERS	
ACCESSORIES	AMPHIBOX-FIX	CO530	WALL MOUNTING KIT FOR AMPHIBOX FLAT	
	AMPHIBOX-ROUND-FIX	CO531	WALL MOUNTING KIT FOR AMPHIBOX ROUND	
	AMPHIBOX-RFID	CO532	RFID SYSTEM	

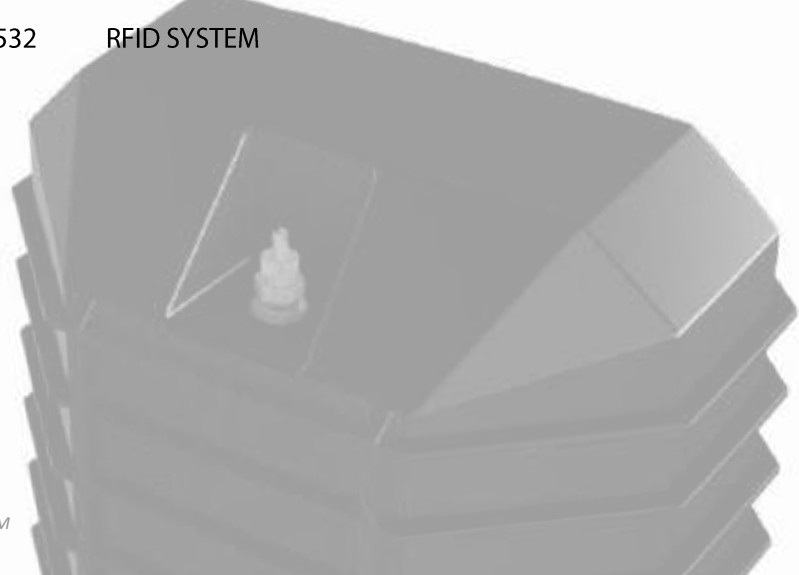

Dans le souci de mieux servir ses clients et d'améliorer les performances de ses produits, OMELCOM se réserve la possibilité de modifier les présentes caractéristiques sans notification préalable